

TYPE "NEO-VAL"
Ball Valve and Bottom Outlet Valve
with PFA-Lining



CE

6.1

- cavity free
- self-lubricating
- vacuum-tight
- complete PFA - lined
- high corrosion-resistance
- full bore
- no seizing of ball



Type "NEO-VAL"

Cavity free Ball Valve - short pattern

- cast stop
- adjusting screw
- stuffing box ring, adjustable
- PTFE - silk packing
- ball and shaft one-piece
- PFA - lining

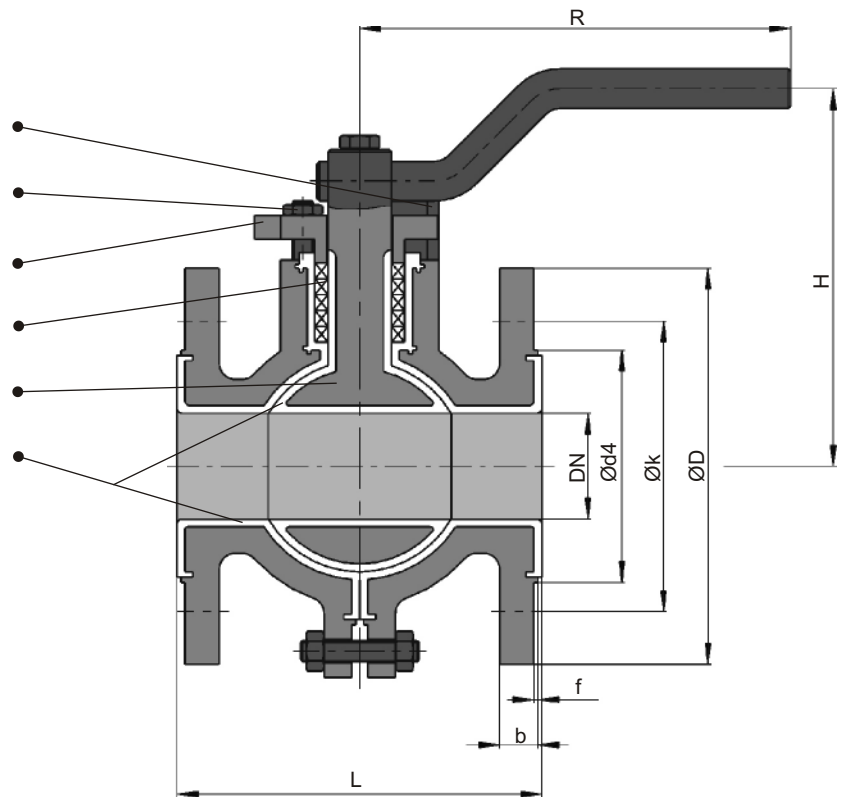

Advantages NEO-VAL

- cavity free
- self lubricating
- high corrosion-resistance against almost all aggressive media.
- full bore
- ball and shaft one-piece
- no seizing of ball

Lining:

Coating thickness: min. 3mm are ensured.

Materials:

code	plug	body	T _{max}
A	1.4408	PFA	210°C
B	PTFE	PFA	200°C
C	PFA-conductive	PFA-conductive	150°C
D	PFA	PFA	130°C
E	PVDF	PVDF	125°C

Other lining materials on request

Note:

We are using only virgin granules, no regenerated materials!

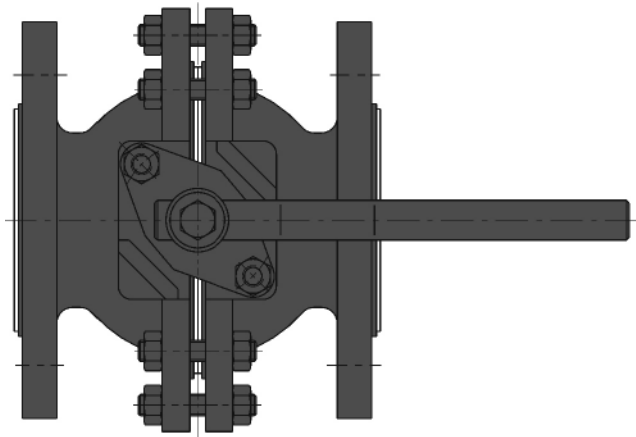

Body Materials:

GGG40.3 / ductile iron, GS-C25 / WCB, stainless steel 1.4408, 1.4308 in each case with PFA/FEP-lining

Ball Materials:

GS-C25 / WCB with lining or 1.4408, 1.4308 without lining

Other materials on request



Type "NEO-VAL"

Cavity free Ball Valve - short pattern

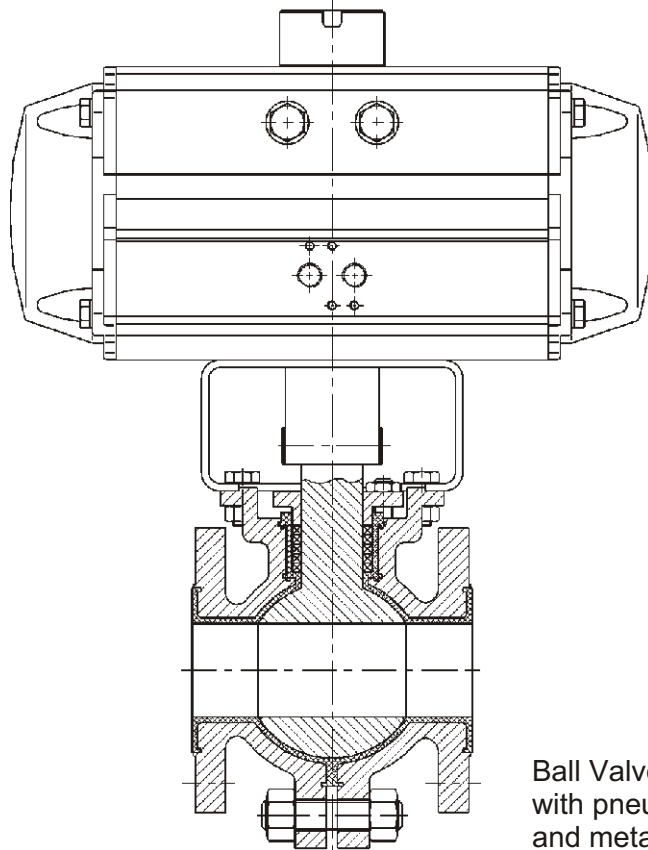

Ball Valve Type "NEO-VAL" with pneumatic 90° actuator and metallic plug.

DIN NEO-VAL Ball Valve												
DN	PN	D	flange holes			b	f	d4	L	R	H	kg
			Øk	No.	Ø							
25	10/40	115	85	4	14	18	2	68	125 ^{*1)}	200	132	7
40		150	110	4	18	18	2	88	140 ^{*1)}	320	143	10
50		165	125	4	18	20	3	102	150 ^{*1)}	420	160	15
80		200	160	8	18	24	3	138	180 ^{*1)}	600	205	26
100	10/16	220	180	8	18	20	3	158	190 ^{*1)}	600	220	29
	25/40	235	190		22	24		162				
150	10/16	285	240	8	22	22	3	212	267 ^{*2)}	reduction gear	*4)	*4)
	25/40	300	250		26	28		218				
200	10/16	340	295	8/12	22	24	3	268	400 ^{*3)}	reduction gear	*4)	*4)
	25	360	310	12	26	30		278				
300	10	445	400	12	22	26	4	370	500 ^{*3)}	reduction gear	*4)	*4)
	16	460	410		28	378						

ANSI NEO-VAL Ball Valve												
ANSI	CLASS	D	flange holes			b	f	d4	L	R	H	kg
			Øk	No.	Ø							
1"	150	108	79,2	4	15,7	14,2	1,6	50,8	125 ^{*1)}	200	132	7
1 1/2"		127	98,6	4	15,7	17,5	1,6	73,2	140 ^{*1)}	320	143	10
2"		152,4	120,7	4	19,1	19,1	1,6	91,9	150 ^{*1)}	420	160	15
3"		190,5	152,4	4	19,1	23,9	1,6	127	180 ^{*1)}	600	205	26
4"		228,6	190,5	8	19,1	23,9	1,6	157,2	190 ^{*1)}	600	220	29
6"		279,4	241,3	8	22,4	25,4	1,6	215,9	267 ^{*2)}	*4)	*4)	*4)
8"		324,9	298,5	8	22,4	28,4	1,6	269,7	400 ^{*3)}	*4)	*4)	*4)

*1) face to face dim. acc. to DIN 3202 Part1 F4 *3) face to face dim. acc. to DIN 3202 Part1 F5
 *2) face to face dim. acc. to ANSI CLASS 150 *4) on request

Order example: K-2-A-DN50-PN25-GGG40.3-C
 K = ball valve, 2 = 2-way, A = lined, DN50 = size,
 PN25 = rating, GGG40.3 = body material, C = lining material

On enquiry / order:
 Please state material for
 body and plug.



Type "KA"

Cavity Free Bottom Outlet Valve

The cavity free Bottom Outlet Valve is based on the design of the cavity free "NEO-VAL" Ball Valve.

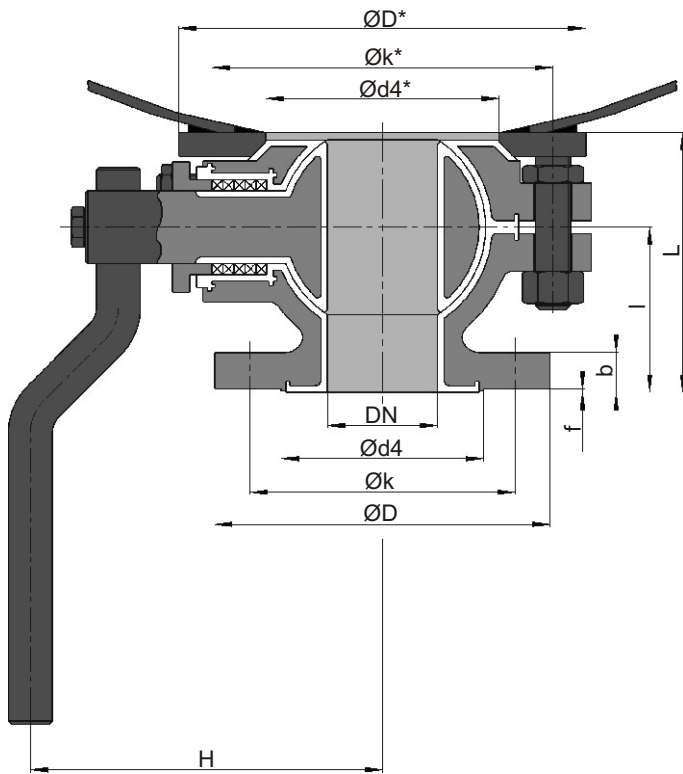
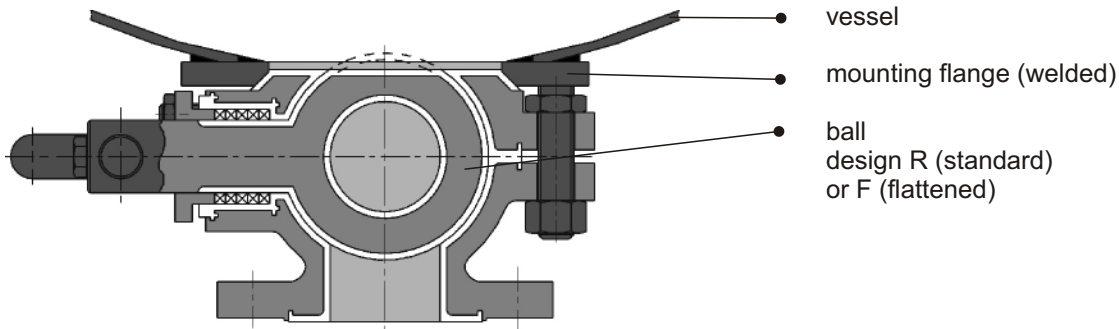

Ball Designs

Design "R" round ball (standard).
 Design "F" flattened ball
 (to get a plane surface in the vessel).

Sampling

On request Bottom Outlet Valves are also in sampling design available.

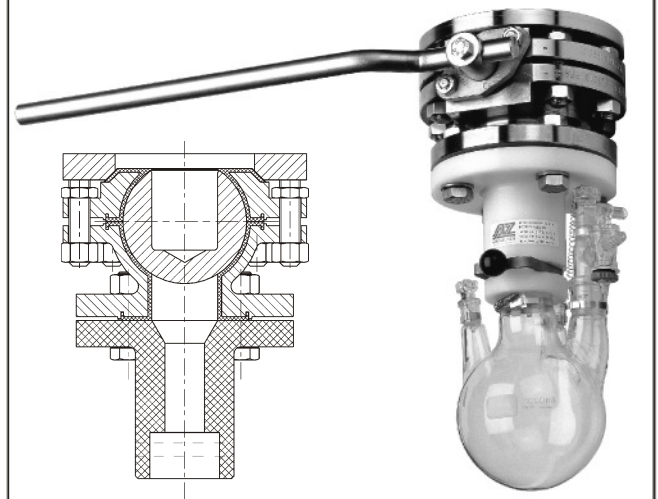

NEO-VAL Bottom Outlet Valve								
DN	PN	vessel connection flange			H	R	L	I
		D*	Øk*	d4*				
25	10/40	140	120	78	132	150	87,5	62,5
40	10/40	180	140	90	143	250	110	70
50	10/40	185	155	106	160	250	122	74
80	10/40	220	195	140	205	300	142	88,5
100	10/40	250	230	140	220	350	160	95
150	10/40	360	310		on request			

Other dimensiones see "NEO-VAL" Ball Valve

Order example: KA-F-2-A-DN80-PN16-GGG40.3-A
 KA = Bottom Outlet Valve, F = plug design, 2 = 2-way,
 A = lined, DN80 = size, PN16 = rating,
 GGG40.3 = body material, A = lining material



AZ-Armaturen GmbH
 D-78087 Mönchweiler
 Waldstraße 7
 Telefon +49 (0)7721 7504-0
 Telefax +49 (0)7721 7504-13
 e-mail: info@az-armaturen.de
<http://www.az-armaturen.de>